



Cam 1
Cyffordd Scott Road

07/07/20 - 10/07/2020

Phase 1
Scott Road Junction

07/07/20 - 10/07/2020

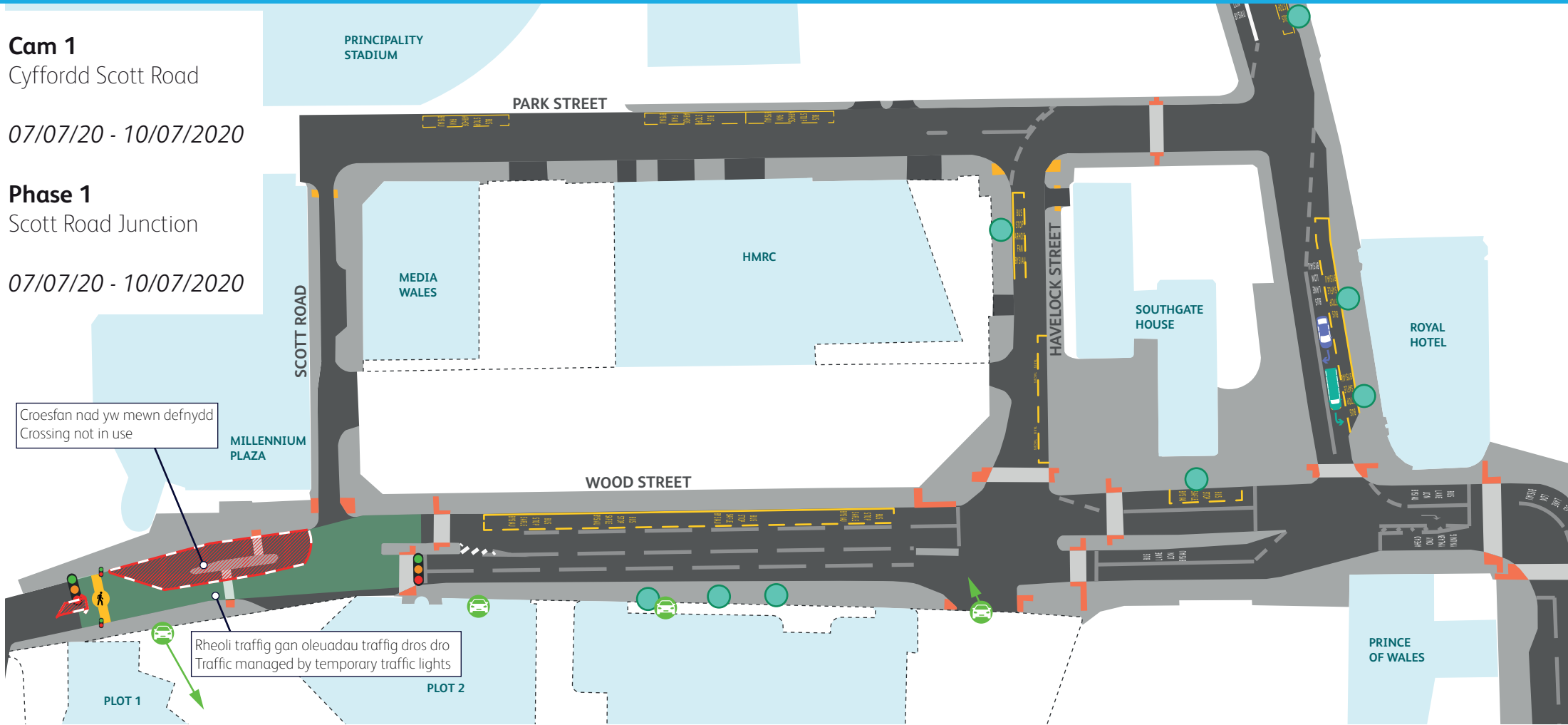

Croesfan nad yw mewn defnydd
Crossing not in use

Rheoli traffig gan oleuadau traffig dros dro
Traffic managed by temporary traffic lights

Cau'n llawn
Full closure

Traffig mynediad yn unig
Access Traffic Only

Cadw mynediad cerbydau
Vehicle Access Maintained

Symudiadau Bws
Bus and taxi movement only

Symudiadau traffig
All traffic

Cyfleusterau bws actif
Active bus facilities

Cyfleusterau bws segru
Inactive bus facilities

Signalau traffig dros dro
Temporary traffic signals

Ardal a reolir gan signalau traffig dros dro
Area controlled by temporary traffic signals

Signalau cerddwyr dros dro
Temporary pedestrian signals

Croesfan cerddwyr dros dro
Temporary pedestrian crossing

Conau
Cone arrangement



Cam 2
 Gwaredu ynys

13/07/2020 -
 20/07/2020





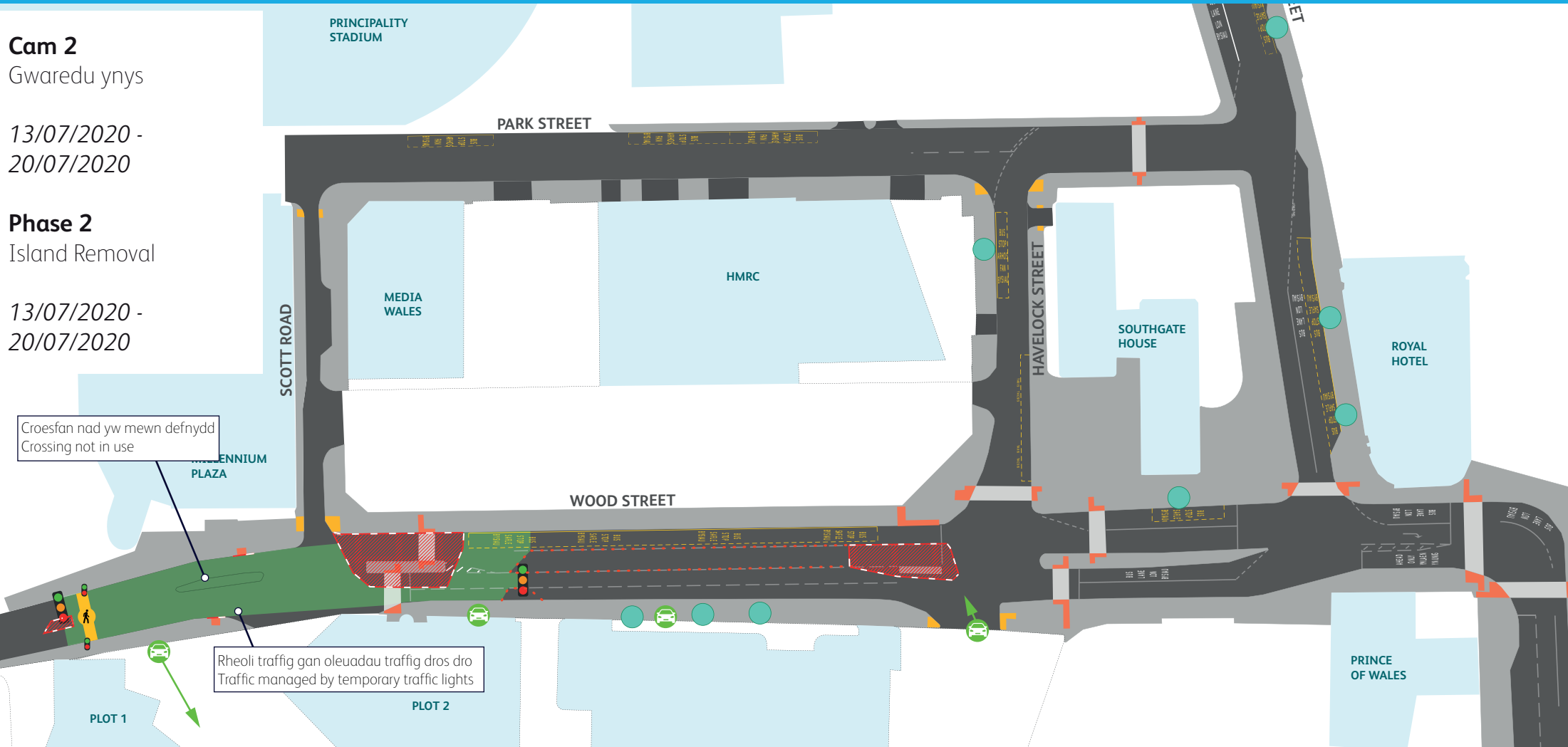







Phase 2
 Island Removal

13/07/2020 -
 20/07/2020



Croesfan nad yw mewn defnydd
 Crossing not in use

Rheoli traffig gan oleuadau traffig dros dro
 Traffic managed by temporary traffic lights

-  Cau'n llawn
Full closure
-  Symudiadau Bws
Bus and taxi movement only
-  Cyfleusterau bws segru
Inactive bus facilities
-  Signalau cerddwyr dros dro
Temporary pedestrian signals
-  Traffig mynediad yn unig
Access Traffic Only
-  Symudiadau traffig
All traffic
-  Signalau traffig dros dro
Temporary traffic signals
-  Croesfan cerddwyr dros dro
Temporary pedestrian crossing
-  Cadw mynediad cerbydau
Vehicle Access Maintained
-  Cyfleusterau bws actif
Active bus facilities
-  Ardal a reolir gan signalau traffig dros dro
Area controlled by temporary traffic signals
-  Conau
Cone arrangement



Cam 3
Gwaredu ynys

20/07/2020 -
27/07/2020

Phase 3
Island Removal

20/07/2020 -
27/07/2020

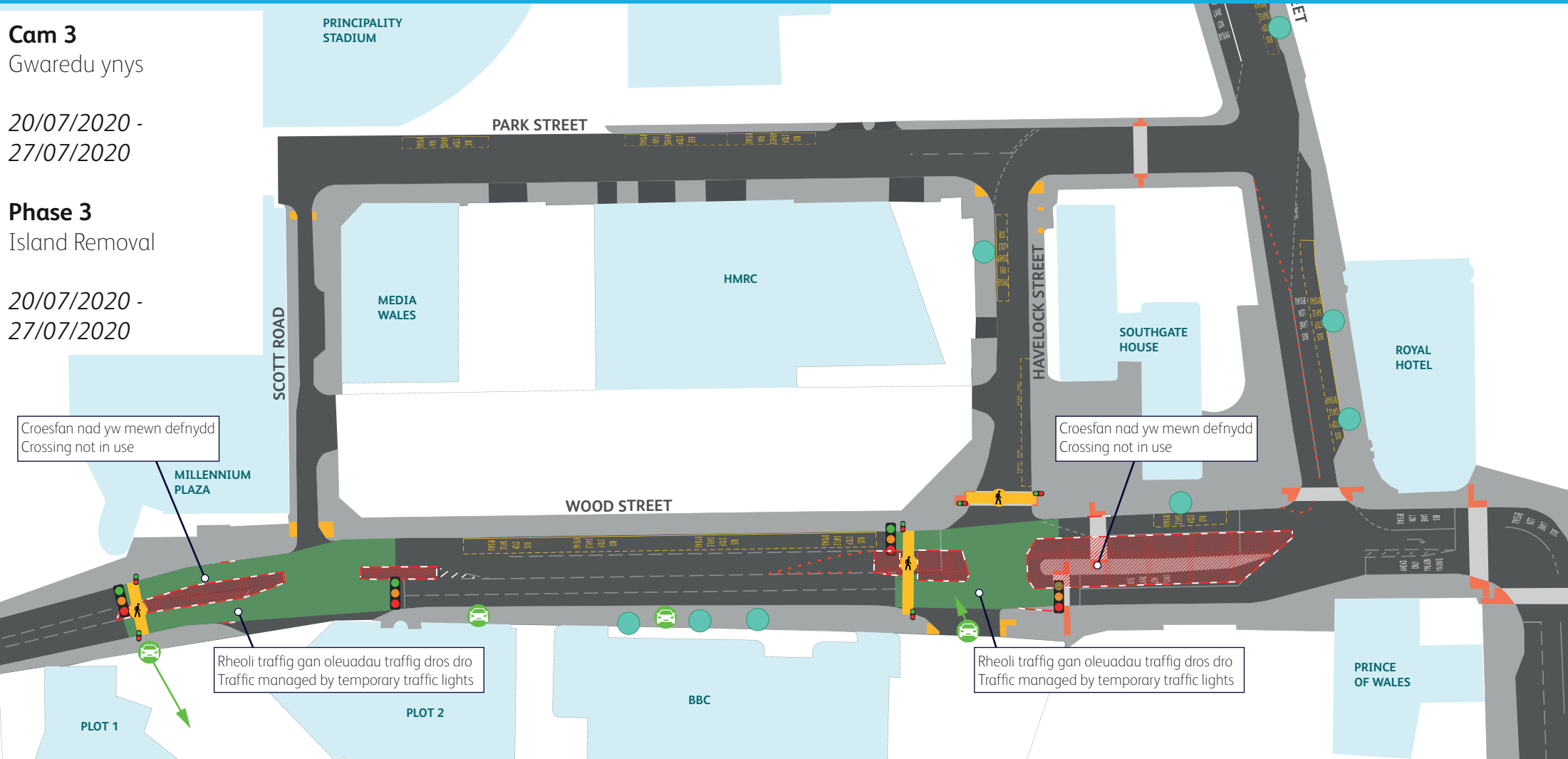













Croesfan nad yw mewn defnydd
Crossing not in use

Croesfan nad yw mewn defnydd
Crossing not in use

Rheoli traffig gan oleuadau traffig dros dro
Traffic managed by temporary traffic lights

Rheoli traffig gan oleuadau traffig dros dro
Traffic managed by temporary traffic lights

-  Cau'n llawn
Full closure
-  Symudiadau Bws
Bus and taxi movement only
-  Cyfleusterau bws segru
Inactive bus facilities
-  Signalau cerddwyr dros dro
Temporary pedestrian signals
-  Traffig mynediad yn unig
Access Traffic Only
-  Symudiadau traffig
All traffic
-  Signalau traffig dros dro
Temporary traffic signals
-  Croesfan cerddwyr dros dro
Temporary pedestrian crossing
-  Cadw mynediad cerbydau
Vehicle Access Maintained
-  Cyfleusterau bws actif
Active bus facilities
-  Ardal a reolir gan signalau traffig dros dro
Area controlled by temporary traffic signals
-  Conau
Cone arrangement

Gweledigaeth Drafnidiaeth Caerdydd

Sgwâr Canolog

Cardiff's Transport Vision

Central Square



Cam 4
Ochr Dde Stryd Wood
27/07/20 - Nadolig 2020

+ Cam 4a
(Gweler cynllun cam 4a ar wahan)
18/08/20-18/11/20

Phase 4
Wood Street South Side
27/07/2020 - Christmas 2020

+ Phase 4a
(See separate phase 4a plan)
18/08/20-18/11/20

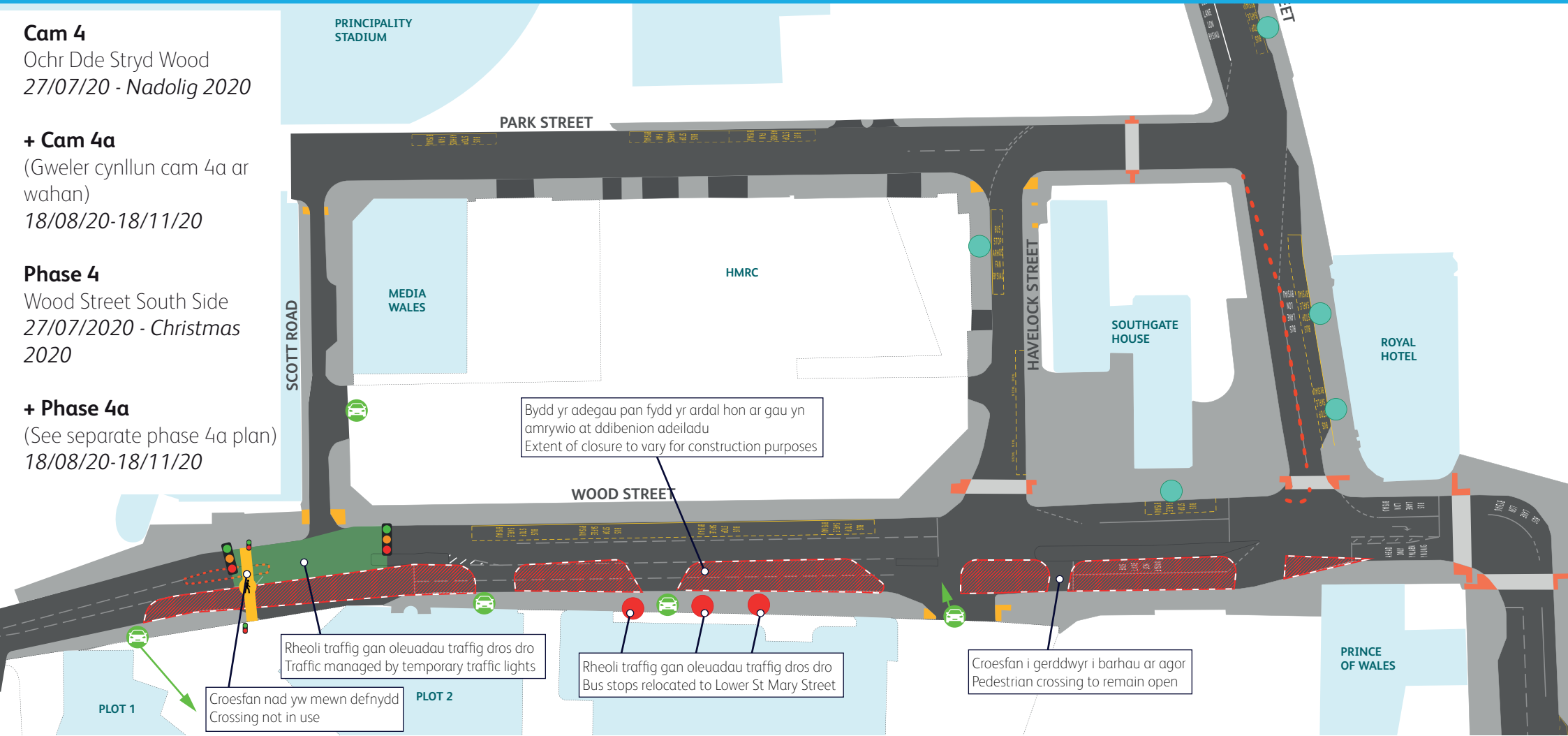









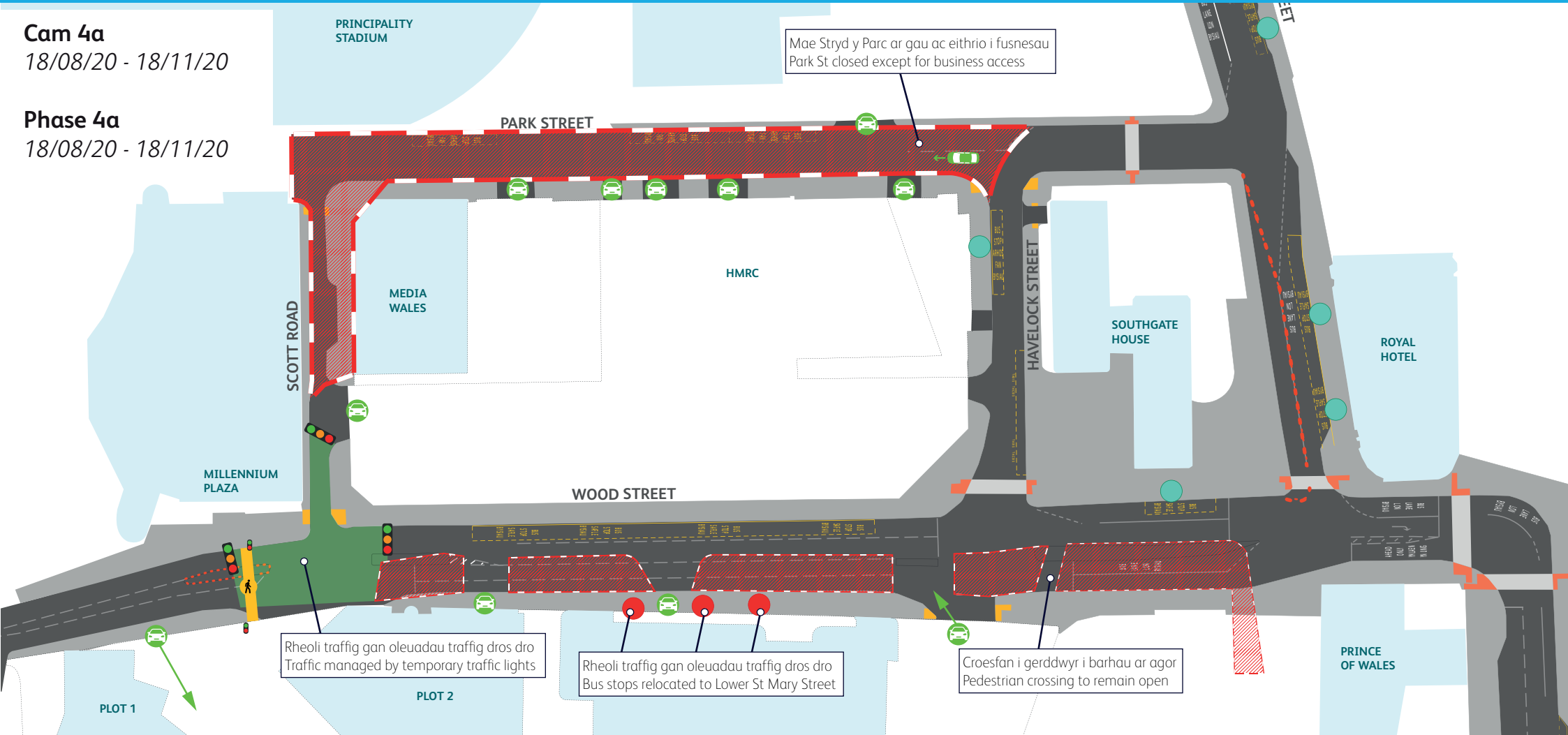



- | | | | | | | | |
|--|---|--|---|--|--|--|---|
| | Cau'n llawn
Full closure | | Symudiadau Bws
Bus and taxi movement only | | Cyfleusterau bws segru
Inactive bus facilities | | Signalau cerddwyr dros dro
Temporary pedestrian signals |
| | Traffig mynediad yn unig
Access Traffic Only | | Symudiadau traffig
All traffic | | Signalau traffig dros dro
Temporary traffic signals | | Croesfan cerddwyr dros dro
Temporary pedestrian crossing |
| | Cadw mynediad cerbydau
Vehicle Access Maintained | | Cyfleusterau bws actif
Active bus facilities | | Ardal a reolir gan signalau traffig dros dro
Area controlled by temporary traffic signals | | Conau
Cone arrangement |



Cam 4a
18/08/20 - 18/11/20

Phase 4a
18/08/20 - 18/11/20



-  Cau'n llawn Full closure
-  Symudiadau Bws Bus and taxi movement only
-  Cyfleusterau bws segru Inactive bus facilities
-  Signalau cerddwyr dros dro Temporary pedestrian signals
-  Traffig mynediad yn unig Access Traffic Only
-  Symudiadau traffig All traffic
-  Signalau traffig dros dro Temporary traffic signals
-  Croesfan cerddwyr dros dro Temporary pedestrian crossing
-  Cadw mynediad cerbydau Vehicle Access Maintained
-  Cyfleusterau bws actif Active bus facilities
-  Ardal a reolir gan signalau traffig dros dro Area controlled by temporary traffic signals
-  Conau Cone arrangement