

Cycleway 1.2

Construction Phase 2

The planned dates for works on the cycleway are as below:

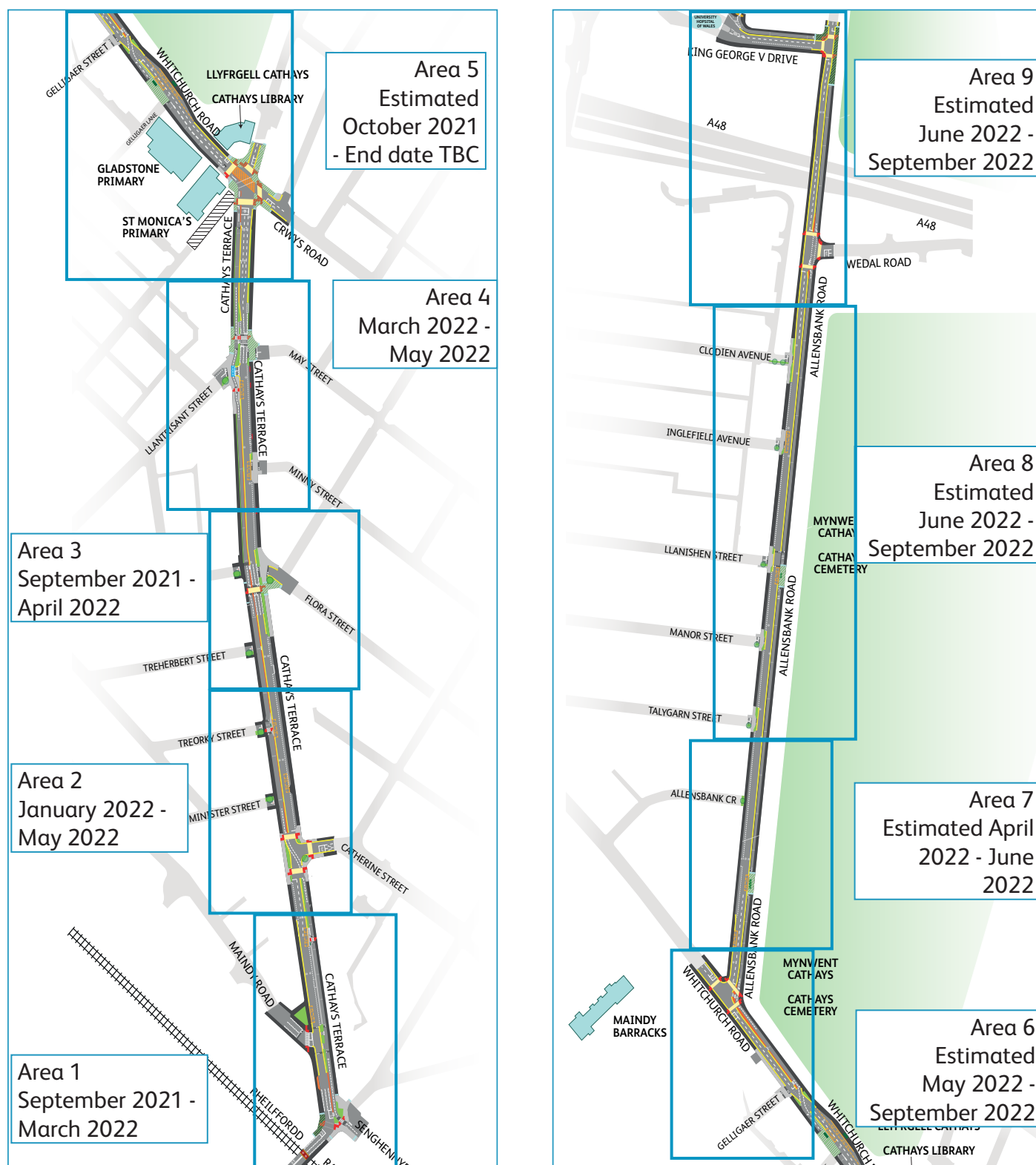

*dates above are for main phases of works, smaller works such as enabling, site set up and utility diversions might take place outside of these dates

Cycleway 1.2

Area 9

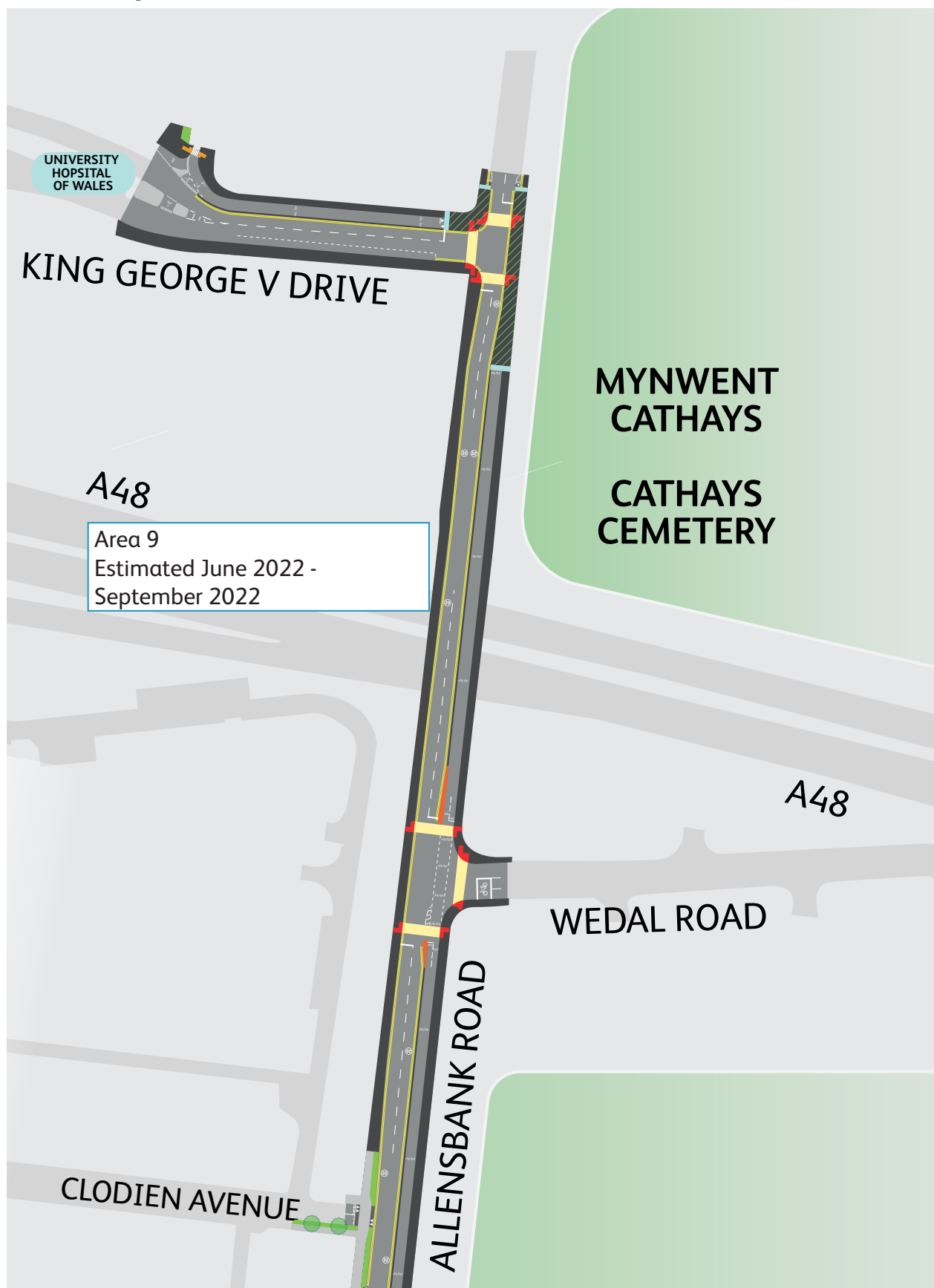

*dates above are for main phases of works, smaller works such as enabling, site set up and utility diversions might take place outside of these dates

Cycleway 1.2

Area 8

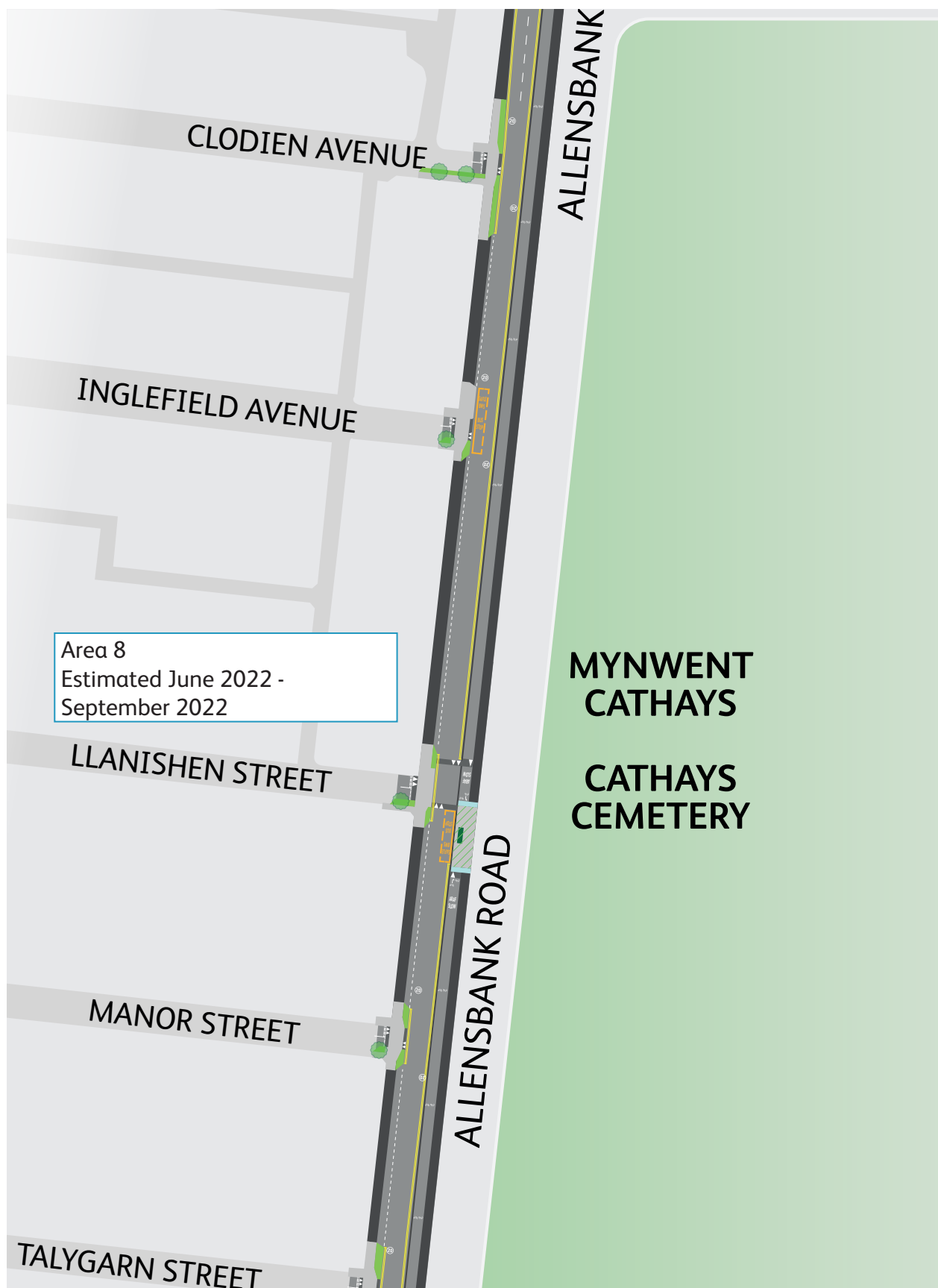

*dates above are for main phases of works, smaller works such as enabling, site set up and utility diversions might take place outside of these dates

Cycleway 1.2

Area 6/7

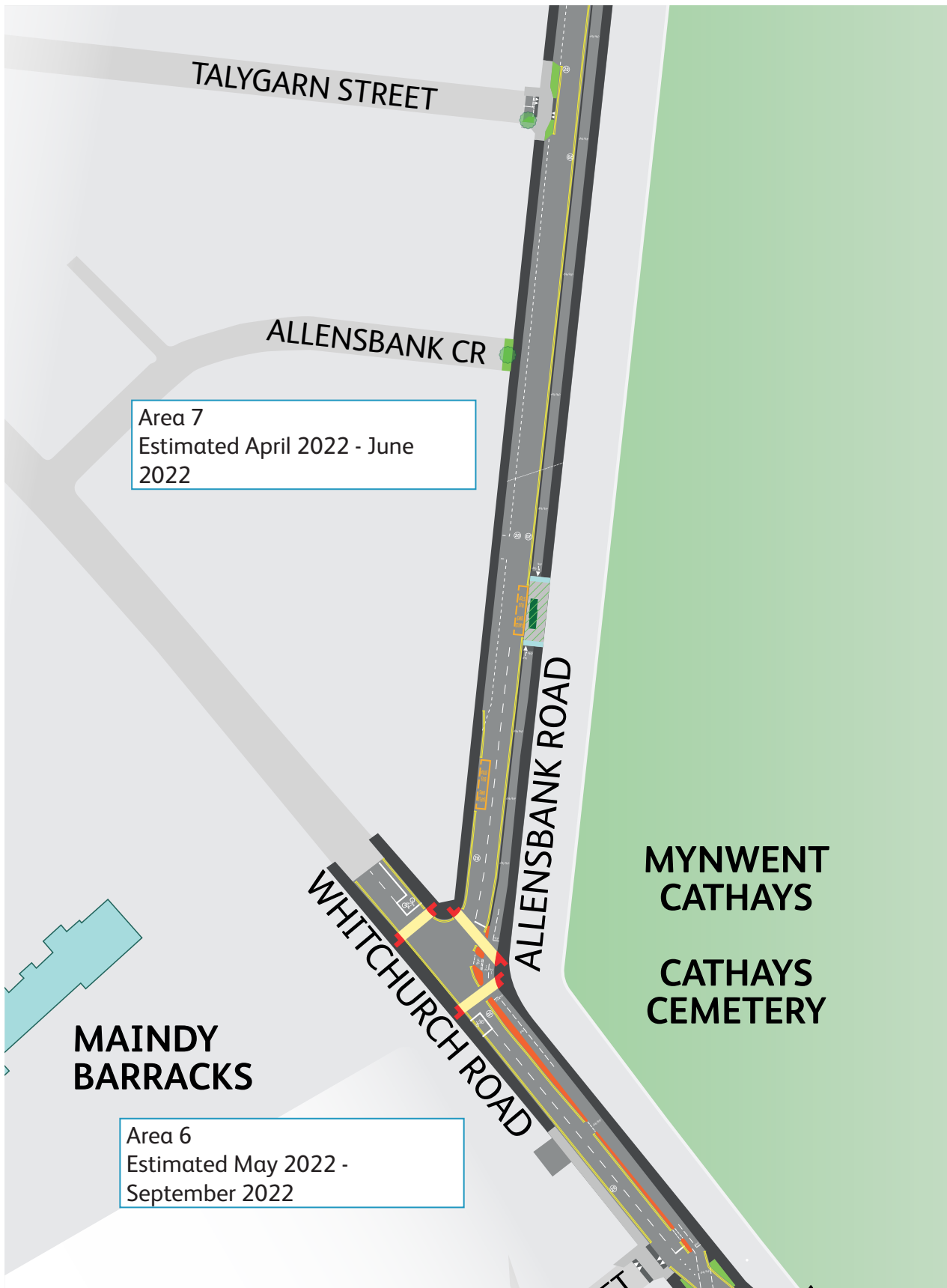

*dates above are for main phases of works, smaller works such as enabling, site set up and utility diversions might take place outside of these dates

Cycleway 1.2

Area 4/5

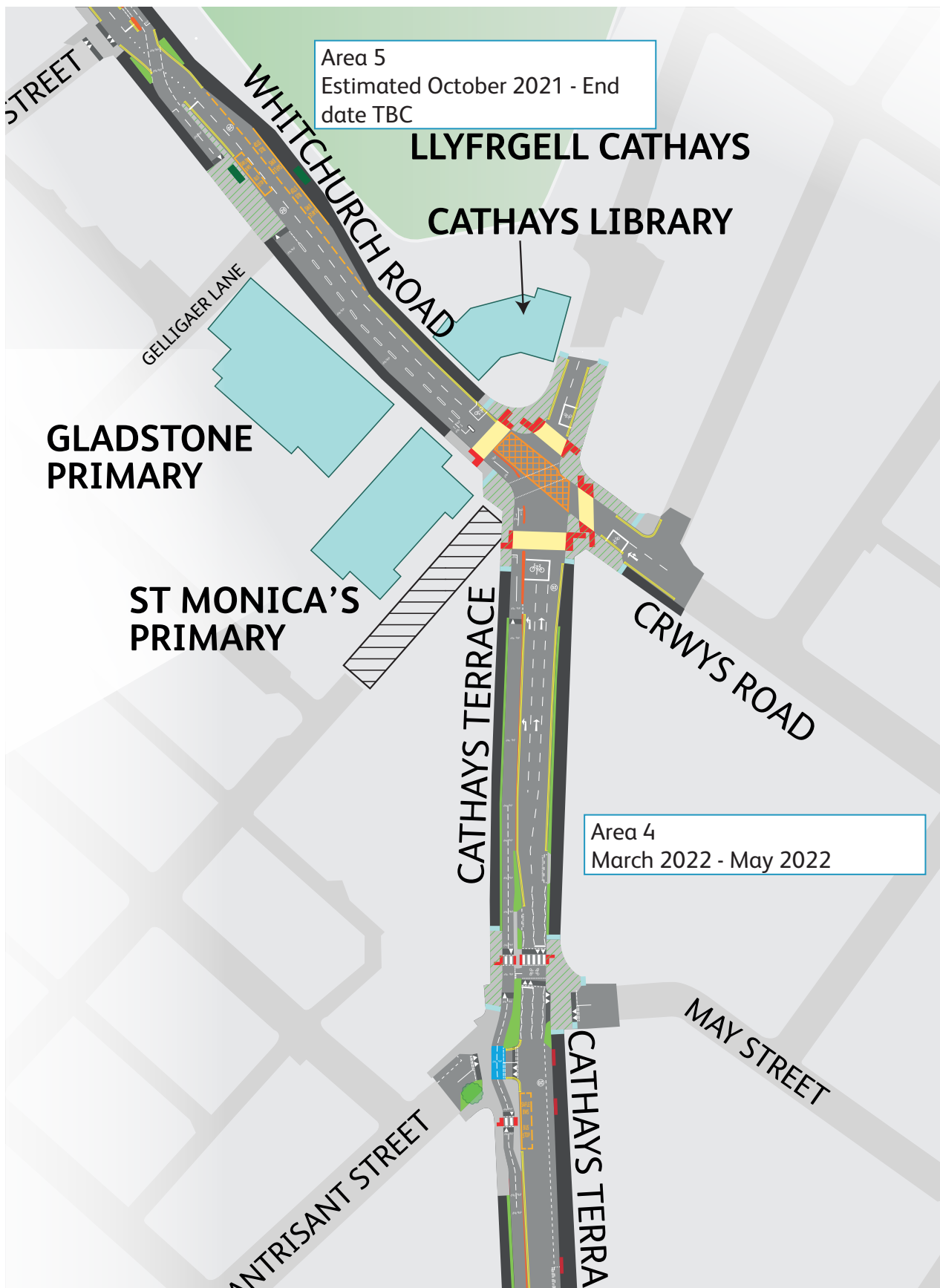

*dates above are for main phases of works, smaller works such as enabling, site set up and utility diversions might take place outside of these dates

Cycleway 1.2

Area 2/3

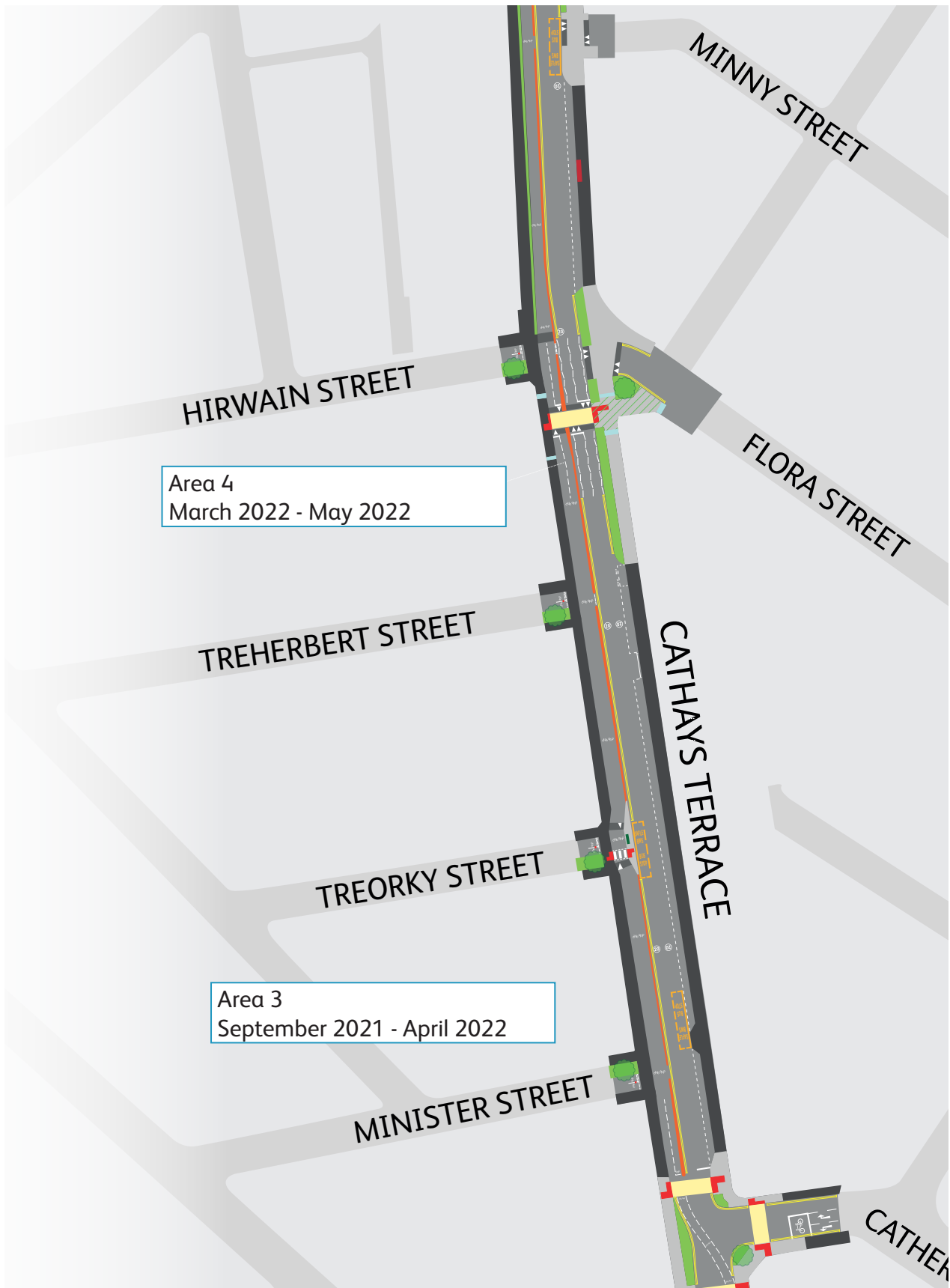

*dates above are for main phases of works, smaller works such as enabling, site set up and utility diversions might take place outside of these dates

Cycleway 1.2

Area 1/2

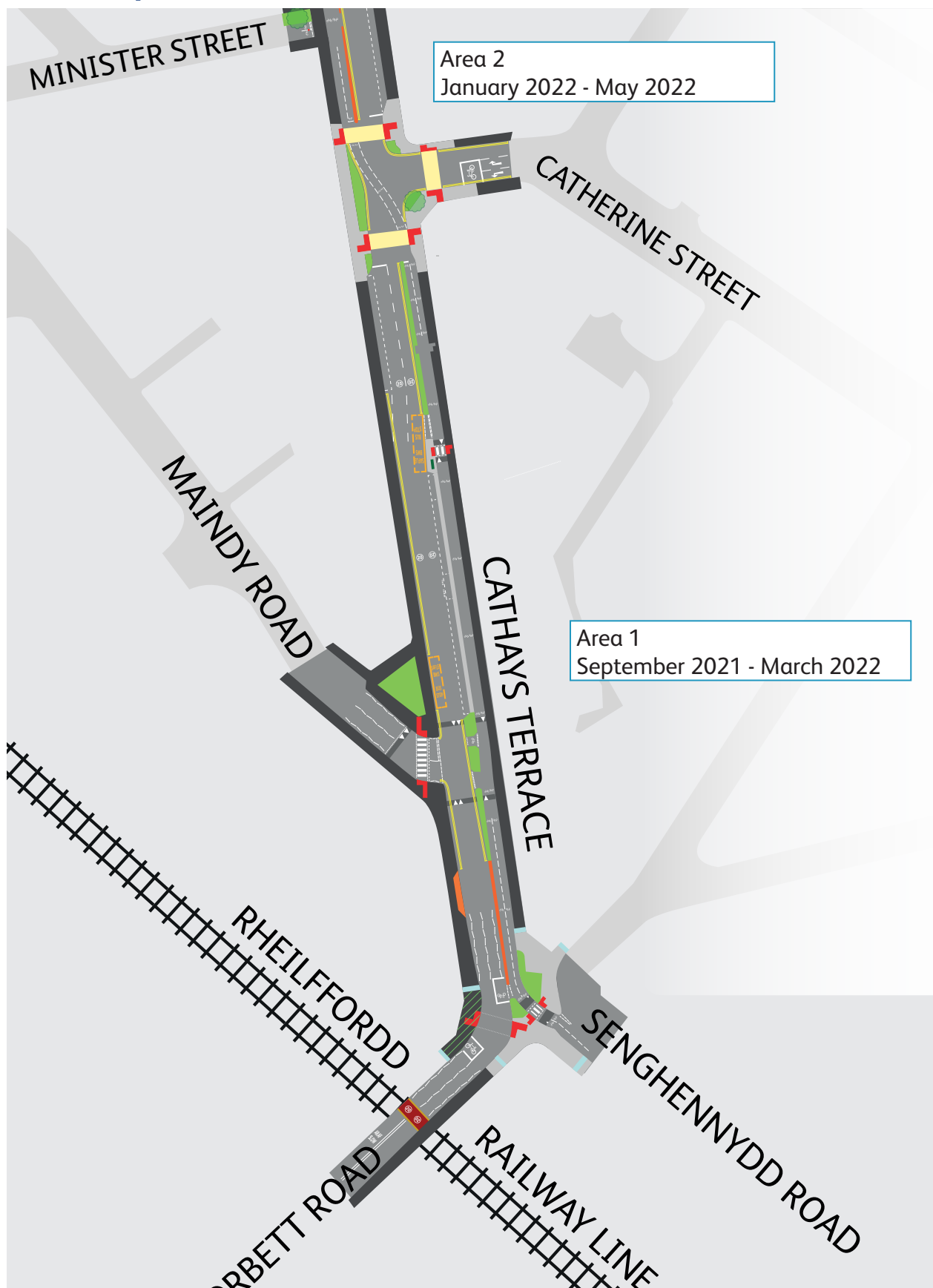

*dates above are for main phases of works, smaller works such as enabling, site set up and utility diversions might take place outside of these dates

Cycleway 1.2 Parking Zones

Parking zones will also be implemented during the construction of the cycleway.

Residents with a residents parking permit for a zone will be able to park in either a residents bay or a limited waiting bay within that zone with no time limit.

For more information on parking permits please visit [Residents Parking \(cardiff.gov.uk\)](https://cardiff.gov.uk/residents-parking)

For more information on parking zones please visit [Parking Zones](#).

